

Kirkmaiden Place Plan



Kirkmaiden Community Local Place Plan
Shaping Our Community's Future Together
2025 -2035
Serving the Communities of Kirkmaiden Parish



A Community-Led Vision for Sustainable Growth and Development

This Place Plan is the collective vision of Kirkmaiden community, based on the responses from the consultation questionnaires, reflecting the aspirations, challenges, and opportunities that we hope will shape the future of our community. Developed through extensive community engagement, this plan serves as a roadmap for positive change, ensuring Kirkmaiden community remains a thriving, inclusive, and sustainable place to live, work, and visit.

 **Community Voices, Local Priorities**

 **Actionable Projects, Measurable Impact**

Developed By

Kirkmaiden Community Council with assistance from Kirkmaiden Steering Group and support from local residents, businesses and key stakeholders with funding and support from Dumfries and Council. The final Plan will be submitted by Kirkmaiden Community Council on behalf of the community.

For More Information

 Visit: [Kirkmaiden Community Council Facebook Page](#)

 Email: colinblt@googlemail.com

Foreword by Kirkmaiden Place Plan Steering Committee



A Vision for Kirkmaiden's Future

Kirkmaiden is more than just a place on the map, it is a vibrant, resilient, and close-knit community with a deep-rooted history and an exciting future. From the picturesque coastline and rolling countryside to the bustling village life in Drummore and Port Logan, this is a place that many proudly call home.

This Place Plan (PP) has been created by and for the people of Kirkmaiden. It reflects the thoughts, ideas and ambitions of those who live and work here, capturing the essence of our community and providing a clear, actionable roadmap for the years ahead. Developed through extensive community consultation, this plan is a testament to the power of collective vision and shared purpose.

Why This Plan Matters

Kirkmaiden faces both opportunities and challenges, whether it's improving local transport, enhancing public spaces, supporting local businesses, or ensuring young people have spaces to thrive. This plan is our opportunity to take charge of our future, ensuring that Kirkmaiden remains a great place to live, work, and visit for generations to come.

A Community Effort

The development of this plan has been a community-driven process. Local residents, businesses, volunteers, and key stakeholders have come together to shape this vision. It is our hope that this document not only guides future decision-making but also serves as a foundation for meaningful action.

To make this vision a reality, we invite everyone, residents, businesses, local authorities, and potential funding partners, to work alongside us in bringing the projects within this plan to life. Whether it's through volunteering, advocating for change, or supporting local initiatives. Your role in this journey is invaluable.

This Place Plan is not just a document, it is a call to action. It represents our aspirations, our priorities, and our collective commitment to a sustainable, thriving, and connected Kirkmaiden. Together, we can build a future that truly reflects the spirit and resilience of our community.

All images reproduced by kind permission of local residents, Scarlett Visuals and children from Drummore Primary School.



Port Logan Lighthouse

Table of Contents

Foreword by Kirkmaiden Place Plan Steering Committee	2
Introduction / Executive Summary	4
Context/Description of the Area	5
Population	5
Housing	6
Transport and Accessibility	6
!Unexpected End of Formula	
Environment and Natural Assets	7
Mull of Galloway	7
Logan Botanic Garden	7
Coastline and Marine Environment	8
Green Spaces and Wildlife	8
Economy and Employment	9
Tourism & Hospitality	9
Cultural & Creative	11
Spiritual	11
Kirkmaiden Old Kirk	12
Historical and Other Assets	13
Agriculture & Fishing	13
Local Businesses & Services	14
Healthcare, Education and Community Services	14
Indoor Community Spaces	14
Conclusion	15
Challenges Facing Kirkmaiden	17

Opportunities for Growth and Development	18
Community/Local Place Plan Objectives	20
Key Objectives	20
1. Strengthen Community and Social Well-being	20
2. Improve Infrastructure, Transport, and Connectivity	20
3. Support Sustainable Economic Growth and Local Businesses	21
4. Ensure Housing Meets Community Needs	21
5. Enhance Tourism in a Responsible and Sustainable Way	21
6. Preserve and Protect Kirkmaiden's Natural Environment	22
7. Improve Local Services and Access to Healthcare	22
8. Strengthen Local Governance and Community Engagement	23
Action Plan	25
1. Drummorie Harbour Regeneration and Coastal Development	25
2. Public Transport	28
3. Traffic Infrastructure Improvements	29
4. Local Business, Employment & Economic Growth Initiatives	30
5. Youth Engagement & Educational Programs	32
6. Environmental Sustainability & Conservation	34
7. Community Skill Development & Volunteering	35
8. Community Cohesion and Well-being	36
9. Better Managed Tourism	38
Asset Development Plan	40
Annex A	41

Introduction / Executive Summary

Kirkmaiden is a unique and beautiful area, rich in heritage, natural beauty, and community spirit. However, like many rural communities, we face challenges such as limited public transport, the need for infrastructure improvements, and opportunities for economic growth. This Place Plan serves as a blueprint for action, helping us address these challenges while making the most of our strengths.

By identifying key priorities and actionable projects, this plan will:

- Strengthen community resilience by addressing local needs and aspirations
- Attract funding by providing a clear, evidence-based strategy for investment
- Influence decision-making at the local authority and national level
- Enhance quality of life by improving services, spaces, and opportunities for all

This Place Plan has been developed through a collaborative, community-led process. Over the past year, we have engaged with residents, businesses, young people, and key stakeholders to gather insights, ideas, and concerns. Our approach included:

- ✓ **Community Surveys** - Gathering input from residents on key issues and priorities (Annex A)
- ✓ **Public Meetings & Workshops** - Discussing challenges and opportunities
- ✓ **Stakeholder Engagement** - Working with local organisations, businesses, and public services
- ✓ **Youth Participation** - Ensuring young people have a say in shaping their future

The result is a clear, actionable, and ambitious plan that aligns with local, regional, and national priorities, ensuring that Kirkmaiden's needs and opportunities are recognised at all levels. See Annex A for more detail on the survey.

This plan is for everyone, residents, local businesses, community groups, landowners, local authorities, and potential funding partners. Whether you have lived here all your life or are new to the area, this is your plan. It is designed to inspire action and encourage collaboration in shaping a sustainable, thriving future for Kirkmaiden.

Our Vision:

A strong, connected, and resilient Kirkmaiden where people of all ages can live, work, and thrive while preserving our natural and cultural heritage.

 **Together, we can make this vision a reality.**

Context/Description of the Area

Kirkmaiden is a rural and coastal community in the Rhins of Galloway, located in the southwest of Scotland. It is known for its stunning landscapes, rich maritime history, strong community ties and lies within the UNESCO Galloway & Southern Ayrshire Biosphere. As the most southerly community in Scotland, the area includes the villages of Drummore, Port Logan, and surrounding hamlets, leading to the Mull of Galloway, Scotland’s southernmost point.

This section provides an overview of the key characteristics of Kirkmaiden, offering insight into the population, housing, transport, environment, economy, and local services that shape life in the area.

Population

Kirkmaiden has a small but engaged population, with a mix of long-term residents, new arrivals, and seasonal visitors.

The demographics indicate

- ✓ A higher proportion of older residents, with many retirees choosing to settle in the area.
- ✓ A smaller number of young families and working-age individuals, reflecting employment challenges and limited local services.
- ✓ A strong sense of community, with many residents actively involved in local initiatives and voluntary groups.

Despite the small population, there is a strong commitment to preserving the area's identity, improving local amenities, and ensuring sustainable growth for future generations.

Age Range

16-24	25-44	45-64	65-74	75+	Blank
1	15	61	49	23	0

Table to show the age range distribution from the respondents

Where do you Live

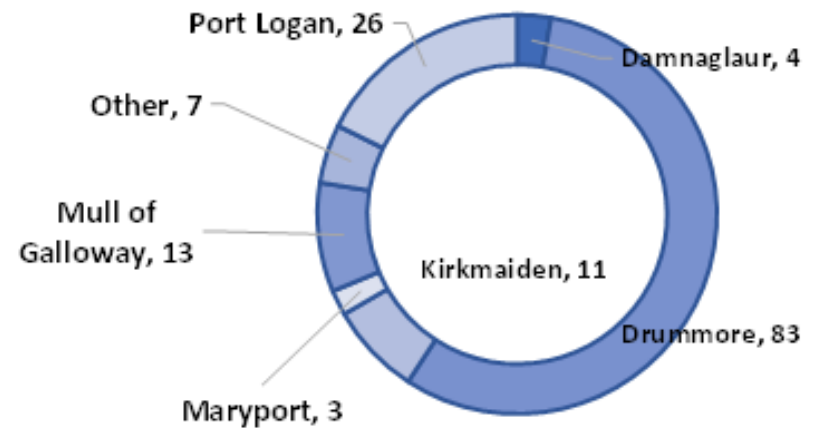

Chart to show where the respondents lived

Housing

The housing in Kirkmaiden consists mainly of:

- 🏡 Rural cottages and farmhouses - Reflecting the area's agricultural and fishing heritage
- 🏠 Village homes in Drummore and Port Logan - Serving as key residential hubs
- 🏡 Holiday lets and second homes - Popular among visitors and supporting local businesses

Key issues include:

- Limited affordable housing for young families and key workers
- High maintenance costs for older properties
- Balancing tourism-related housing with local needs

Addressing these issues is a priority, ensuring that Kirkmaiden remains a place where people can live and work year-round.



View Includes Private, Commercial and Council Properties

Transport and Accessibility

🚗 Road Infrastructure

Kirkmaiden is primarily accessed via the A716 from Stranraer, the nearest town with wider services. The road network, while scenic, presents challenges:

- Narrow roads and limited passing places
- Concerns over road maintenance and potholes
- Speeding issues in village areas
- The A716 is closed during severe high tides and stormy weather with only a minor road servicing the community
- The A716 is, in part, the only access road to the community which can become isolated if it is blocked between Ardwell and Logan Toll.

🚌 Public Transport

Public transport is limited, with an infrequent bus service connecting Kirkmaiden to Stranraer. Key issues include:

- ✓ Lack of early morning, evening and Sunday services
- ✓ Challenges for young people and the elderly in accessing essential services
- ✓ Potential for community transport initiatives to bridge the gap

Active Travel

There is significant interest in:

- Enhancing walking and cycling paths for residents and tourists
- Developing safer pedestrian routes within villages
- Improving connections to scenic coastal and countryside trails (Rhins of Galloway Coastal Path)



The Art Trail, Low Road, Drummore

Environment and Natural Assets

Kirkmaiden is one of the most naturally beautiful and ecologically important areas in Scotland. Key environmental assets include:

Mull of Galloway

- Scotland's southernmost point, offering spectacular views and the famous Mull of Galloway lighthouse.
- An extensive NatureScot Special Area of Conservation (SAC) and Site of Special Scientific Interest (SSSI) including the entirety of the Mull coastline and several miles along the community's Western coast.
- A nature reserve managed by RSPB, home to diverse birdlife and marine species.

Logan Botanic Garden

- A botanical garden in the North of the Kirkmaiden community. It is operated as part of the Royal Botanic Garden Edinburgh's Living Collection and has been described as "Scotland's most exotic garden."



Logan Botanical Gardens

Coastline and Marine Environment

- South Rhins Coastline provide important coastal habitats
- Sustainable fishing and marine conservation are key concerns
- Potential for eco-tourism and responsible coastal development

Green Spaces and Wildlife

- Logan House Gardens. A mature arboretum and gardens seasonally open to the public.
- Abundant biodiversity, including rare plant species and migratory birds
- Opportunities for conservation projects and biodiversity initiatives

While these natural assets are a source of pride, challenges such as coastal erosion, invasive species, and littering need to be addressed through sustainable management.





Economy and Employment

The local economy is diverse but faces challenges due to rural isolation. The main sectors include:

Tourism & Hospitality

Visitors are drawn to the

- **Mull of Galloway Lighthouse** and surrounding **RSPB reserve** and **SSSi**. The lighthouse being situated at Scotland's most southerly point, the location of the Mull of Galloway lighthouse, built by Robert Stevenson between 1828 and 1830, and home to the Mull of Galloway experience. Now managed by the Mull of Galloway Trust.



The Mull of Galloway Lighthouse

- **Logan Botanic Garden** a popular botanical garden within the parish, operated as part of the Royal Botanic Garden Edinburgh's Living Collection, and has been described as "Scotland's most exotic garden."

- **Coastal scenery, and outdoor activities** especially fishing and walking.
- **The Port Logan Fishpond**, the UK's oldest natural marine aquarium, provides a unique & popular visitor attraction & information centre.



Port Logan Fishpond

- **Seasonal businesses** support the economy but need to develop year-round sustainability

- **Several hospitality venues**, partly seasonal, including The Ship Inn, Queen's Hotel, Clashwhannon, Mariner's Coffee House, Gallie Craig and the Potting Shed.
- Static caravan parks (Clashwhannon & Maryport) and touring parks (New England Bay & Muldaddie).
- **The Mull of Gallery**, Scotland's most southerly art gallery and workshop space. It offers tourists local art from Kirkmaiden residents. Opened in 2016 and open all year round, the in-house artist offers workshops for adults and children and promotes the visual arts in the parish.



Mull of Gallery



Farming

There are several active farms within the community operating mainly dairy, beef & sheep farming. Farmland accounts for the bulk of the land within the community.

Cultural & Creative

In Kirkmaiden Parish there are numerous creative groups and individuals practising their art forms.

Visual artists and makers cover many disciplines including painting and drawing, textiles, wood turning, jewellery, felt making, blacksmithing forge, knit and crochet and photography to name a few. These extend from hobbyists to professional artists and include showcasing their work within the parish at various venues, to exhibiting in the Community Hub and also outside the parish at venues such as art galleries and major events outside the parish. There are a number of full-time artists and galleries and studios in the parish. There are also workshop opportunities for residents and visitors. There is a film club which runs for certain months of the year throughout winter time within the parish.

Kirkmaiden parish has a wealth of musicians, from folk evenings, open mic nights and visiting bands performing in local pubs. There are bagpipe musicians and brass musicians involved in events throughout the year. There are venues which can accommodate larger gatherings/parties for bands outside the parish and also our musicians are involved in events all across the Rhins of Galloway and beyond.

Creative writing and local history talks/groups feature widely in the parish and have a large presence in the local area.

There is a strong tradition of Scottish Women's Institute and Mull SWI established in 1930, which continues to meet monthly and participates in many rural activities and shows throughout Scotland.

Spiritual

St Medan's Church, Stair Street, Drummore, serves the Parish of Kirkmaiden within South West Presbytery of the Church of Scotland. Weekly Services are held on Sundays at 10.30 a.m. when all are welcome. Tea/coffee/cake and fellowship are at close of services. Special Services are held on Church Festivals e.g. Lent, Easter and Remembrance Service and Christmas. Close connections exist with the young people of the Parish who regularly take part in services.



St Medan's Church

Kirkmaiden Old Kirk

The Old Kirk occupies a hilltop position with commanding views of the surrounding parish. The Old Kirk succeeded previous kirks and chapels dedicated to St. Medan from whom the parish is supposed to have derived its name. The Old Kirk was founded in 1638, the year of the National Covenant, and so it is frequently referred to as the Kirk Covenant.

The building is listed as Category A, this denotes a building of national or international importance for its architecture or history. The kirk itself is of a very simple T form layout with the minimum of decoration and therefore preserves the feel of an ancient building. It does contain some important items relating to the parish including the bell dated 1534 and a triangular wooden panel dated 1618 which relates to the Adair family of Drummore Castle. The surrounding churchyard and adjacent cemetery (currently maintained and managed by Dumfries and Galloway Council), contains some very fine and in some cases, unique memorials.

The Old Kirk has been at the centre of both religious and secular parish life for nearly four hundred years. The building has witnessed the worship, christenings, marriages and burials of generations of people from the parish. It appears in folk tales and legends, was familiar to the notorious Mull of Galloway smugglers and has been used as a location in film and television productions.

Presently the Old Kirk is the property of the Church of Scotland, but it is one of a large number of buildings that the Church of Scotland wishes to dispose of. In response to this the residents of Kirkmaiden formed a fully constituted Scottish Charitable Incorporated Organisation (SCIO) with a view to acquiring the building, preserving it and taking it forward for the future.

If the SCIO is successful in acquiring the Old Kirk the building will be deconsecrated, but still able to host life events such as naming ceremonies, weddings and non-denominational faith events. The SCIO also hopes to use the building for the advancement of the arts, heritage, culture and science by linking with local history groups, schools and the wider public.

At the time of writing (July 2025) negotiations between the SCIO and the Church of Scotland are ongoing.



The Old Kirk, Kirkmaiden

Historical and Other Assets

For its relatively small size the community is rich in its historical heritage.

- **Kirkmaiden Old Kirk & Churchyard**
- **St Catherine's Croft**, the ancient **Kirkmaiden Church** and nearby **St Medan's cave**
- **Historic fishing villages Port Logan & Drummore** with a unique maritime heritage including a role in WW2 defence activities.



View of Port Logan

- Historical sites including **Castle Clanyard**, **High Drummore motte** and **Logan Windmill**.
- **St Medans Masonic Lodge**, and the former church hall now **Drummore Arts & Crafts Centre**.
- **Drummore Bowling Club**. Established in 1908 and has been running continuously since. It has struggled in recent years but is currently being revitalised, aiming to reach further into the resident & visitor communities and especially looking to attract interest from younger people and families.



Drummore Bowling Club

Agriculture & Fishing

- Farming remains a cornerstone of the local economy, with both traditional livestock and modern diversification.
- Small-scale fishing and seafood industries provide employment but face market and sustainability pressures.



Fishing boats launching on the shore at Drummore

Local Businesses & Services

- Limited retail and service options within the villages with a shop/Post Office serving the community as a whole.
- Need for digital infrastructure improvements to support remote working and entrepreneurship

A key focus of this plan is to expand economic opportunities, support small businesses, and encourage sustainable tourism growth.



Post Box VE Day Knitted Cover

Healthcare, Education and Community Services

Healthcare

- The community is fortunate to have local GP services providing prompt initial care, however secondary care requires residents traveling to Stranraer or Dumfries dependent on the intervention required.
- Concerns over emergency response times due to rural location and potential for being cut-off
- Opportunities for telemedicine and mobile healthcare solutions

Education and Youth Services

- **Drummore Primary School** and **Early Learning Centre** serves the local community, but secondary education requires travel by bus to Stranraer.
- There is a lack of youth-focused spaces and activities



Drummore Primary and ELC

Indoor Community Spaces

Village halls and community groups play a vital role in social life. The parish has four community spaces.

- The Kirkmaiden Community Hub in Drummore managed and maintained by the Kirkmaiden Community Hub Committee. This is available for community meetings and the hire of smaller rooms over two floors.



Kirkmaiden Community Hub

- Drummore Arts & Crafts Centre, an independent centre aiming to promote local arts & crafts and offering a hall facility for hire.
- St. Medans Church facilitates larger public meetings.

Expanding facilities for local events, learning, and recreation is a priority.

- Port Logan Hall is the Community Village Hall for Port Logan and is used for a range of village activities, such as Port Logan Cinema, and can be hired for events.



Port Logan Community Village Hall

Conclusion

Kirkmaiden is a beautiful and deeply connected community, rich in history, natural beauty, and potential. However, challenges in housing, transport, employment, and public services must be addressed to ensure long-term sustainability.

This Place Plan provides a clear strategy to strengthen the community, improve infrastructure, and unlock opportunities for the future. By working together, we can make Kirkmaiden an even better place to live, work, and visit for generations to come.

Challenges Facing Kirkmaiden

While Kirkmaiden has many strengths and opportunities, there are key challenges that need to be tackled to ensure sustainable progress.

Rural Isolation and Accessibility

- Limited public transport services create barriers for those without private vehicles
- Access to healthcare, education, and essential services requires long travel times
- Weather-related disruptions can further isolate communities

Population Decline and Aging Demographics

- The decline in young families and working-age residents impacts local services and businesses
- Lack of affordable housing and job opportunities contributes to youth migration
- A growing elderly population requires more health and social care support as per respondents

Economic Challenges

- Seasonal nature of tourism means economic activity fluctuates
- Limited employment diversity - few opportunities outside tourism and agriculture
- Struggles for small businesses due to rural location and high operational costs

Infrastructure and Development Barriers

- Aging infrastructure and road networks require investment
- Lack of investment in broadband and digital connectivity affects remote working potential
- Sustainability concerns regarding waste management, energy efficiency, and conservation



A716 Traffic Management

Addressing these challenges will require collaboration between residents, local authorities, and funding partners to ensure long-term resilience and prosperity for Kirkmaiden.

Opportunities for Growth and Development

Kirkmaiden has significant untapped potential that, if nurtured, can support long-term sustainability, economic resilience, and community well-being.

Sustainable Tourism & Eco-Tourism

- ✓ Enhance visitor experiences through better tourism infrastructure (signage, parking, information points)
- ✓ Promote responsible tourism that benefits the local community and environment
- ✓ Expand eco-tourism initiatives such as wildlife tours, walking trails, and marine conservation activities



Economic Development & Local Business Growth

- ✓ Encourage remote working and digital business opportunities with improved broadband
- ✓ Develop community-run enterprises such as local produce markets and craft hubs

- ✓ Support local entrepreneurs and small businesses to create jobs and services



Drummore Village Shop and Post Office

Improving Transport & Accessibility

- ✓ Advocate for better public transport links to Stranraer
- ✓ Develop community transport options such as a shared minibus or volunteer driver schemes
- ✓ Improve walking and cycling infrastructure for residents and visitors



Housing & Sustainable Living

- ✓ Explore affordable housing solutions for young families and key workers
- ✓ Encourage eco-friendly housing developments in keeping with the local character
- ✓ Support home renovation and energy efficiency schemes



Strengthening Community & Social Infrastructure

- ✓ Expand youth and family-friendly activities to retain young people in the area
- ✓ Improve community facilities and event spaces
- ✓ Develop health and well-being programs tailored to rural needs

These opportunities align with the priorities of local residents, ensuring growth is balanced with sustainability and community well-being.

Community/Local Place Plan Objectives

Our Vision for Kirkmaiden

Kirkmaiden is a beautiful, resilient, and close-knit community, rich in history, natural beauty, and local pride. This Place Plan sets out a clear vision to ensure Kirkmaiden thrives as a sustainable, connected, and inclusive community where people of all ages can live, work, and enjoy a high quality of life.

Our objectives focus on protecting what makes Kirkmaiden special, while ensuring future growth and improvements meet the needs of residents, businesses, and visitors.

Key Objectives

1. Strengthen Community and Social Well-being

- ✓ Support local events, initiatives, and shared spaces to bring the community together
- ✓ Expand youth engagement and activities to retain young families in the area
- ✓ Develop support networks for elderly residents, reducing isolation and improving well-being
- ✓ Encourage volunteering and community-led projects that enhance social cohesion

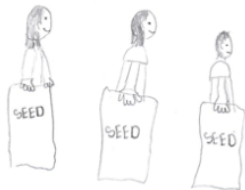

(This document has been prepared in accordance with the Scottish Government's Local Place Plan framework and aims to align with the Local Development Plan and national policy priorities.)



Christmas Carols with the Children from Drummore Primary

2. Improve Infrastructure, Transport, and Connectivity

- ✓ Advocate for better public transport services to Stranraer and beyond
- ✓ Improve road safety, maintenance, and pedestrian-friendly routes in key areas
- ✓ Enhance walking and cycling networks, promoting active travel and tourism
- ✓ Support broadband and mobile connectivity improvements for residents and businesses

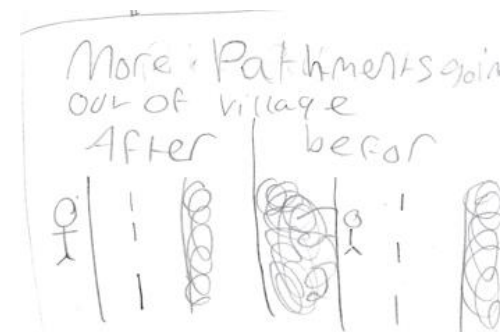

3. Support Sustainable Economic Growth and Local Businesses

- ✓ Create more year-round job opportunities to reduce reliance on seasonal employment
- ✓ Support small businesses, entrepreneurs, and digital-based work in the community
- ✓ Encourage farm diversification, eco-tourism, and sustainable local industries
- ✓ Promote local produce and crafts, supporting farmers' markets and small-scale retail

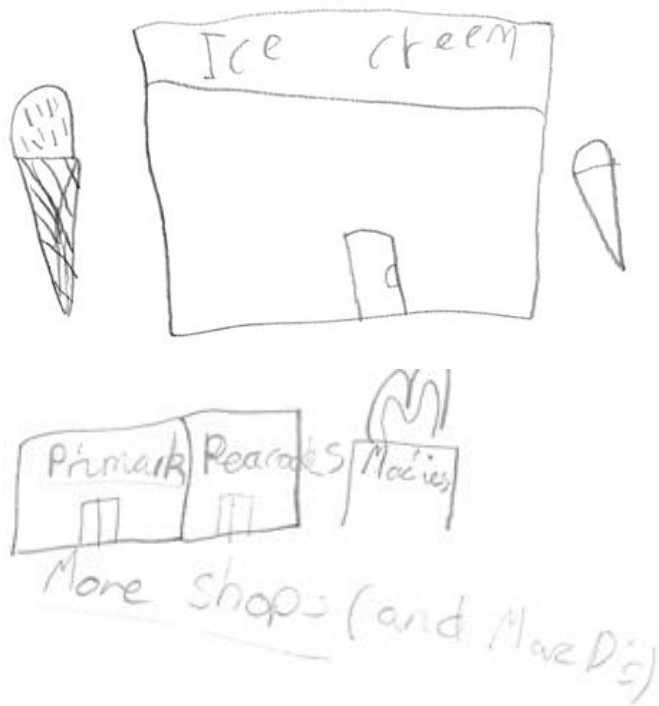

4. Ensure Housing Meets Community Needs

- ✓ Advocate for affordable housing solutions to attract and retain young families
- ✓ Support renovation grants and sustainable housing initiatives for existing properties
- ✓ Ensure new housing developments are in keeping with the local character and needs

5. Enhance Tourism in a Responsible and Sustainable Way

- ✓ Develop eco-friendly tourism opportunities that respect the local environment
- ✓ Improve visitor facilities, including signage, parking, and information points
- ✓ Protect historical landmarks, heritage sites, and local identity
- ✓ Ensure tourism benefits local businesses and community interests, not just visitors



Devil's Bridge

6. Preserve and Protect Kirkmaiden's Natural Environment

- ✓ Enhance coastal and countryside conservation efforts, tackling litter and pollution
- ✓ Promote community-led sustainability initiatives, such as tree planting and recycling
- ✓ Support marine conservation and responsible fishing practices
- ✓ Develop educational programs on environmental responsibility for residents and visitors



7. Improve Local Services and Access to Healthcare

- ✓ Advocate for better access to GP services and healthcare support in rural areas
- ✓ Expand telehealth services and mobile healthcare options
- ✓ Develop elderly care support networks, ensuring no resident is left isolated
- ✓ Improve childcare options to support local working families



Local GP Practice

8. Strengthen Local Governance and Community Engagement

- ✓ Ensure residents have a stronger voice in decision-making processes
- ✓ Improve communication between local authorities and community groups
- ✓ Promote participatory budgeting to allocate funding based on community needs
- ✓ Encourage more local involvement in planning and development decisions



Delivering Change Together

Achieving these objectives will require collaboration and commitment from:

👉 **Local residents** - Getting involved in shaping and delivering key projects

🏛️ **Local and regional authorities** - Providing support, funding, and policy alignment

👛 **Businesses and entrepreneurs** - Driving economic sustainability and innovation

🌍 **Community groups and volunteers** - Leading initiatives and engagement

This Place Plan provides a roadmap for progress and positive change, ensuring Kirkmaiden remains a vibrant, sustainable, and thriving community for future generations.

📍 Together, we can create a stronger, more connected Kirkmaiden.

Kirkmaiden LPP Infographic | Nov. 2024

Locations

Where do yo...

- Damnaglair
- Drummore
- Kirkmaiden
- Maryport
- Mull of Galloway
- Other
- Port Logan

Stay years

How long have yo...

- 1
- 1.5
- 11
- 12

How woul...

- Leisure
- Live
- NHS
- Visit
- Work

Plan to stay in 10 yrs

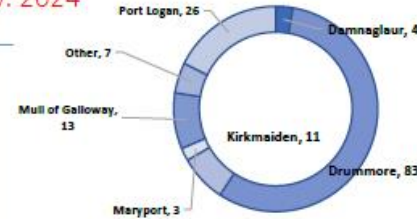
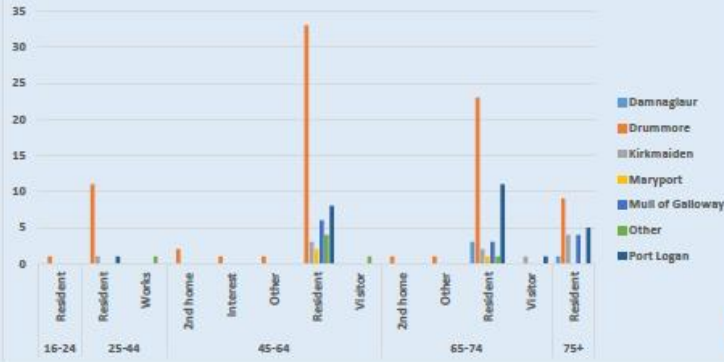

Respondent
149

Do you plan residing ...

- (blank)
- Don't Know
- N
- Y

How would y...

- Digital connect...
- Facilities & Ser...
- Feeling Safe
- Identity & Belo...
- Influence
- Moving around
- Natural Spaces
- Other
- Play & Recreati...
- Public Transport
- Social Care
- Tourism

Kirkmaiden LPP Survey

Overall Community Ratings



Rating life aspects

Chart Showing Weighted Score Out of 5 (5 Good)

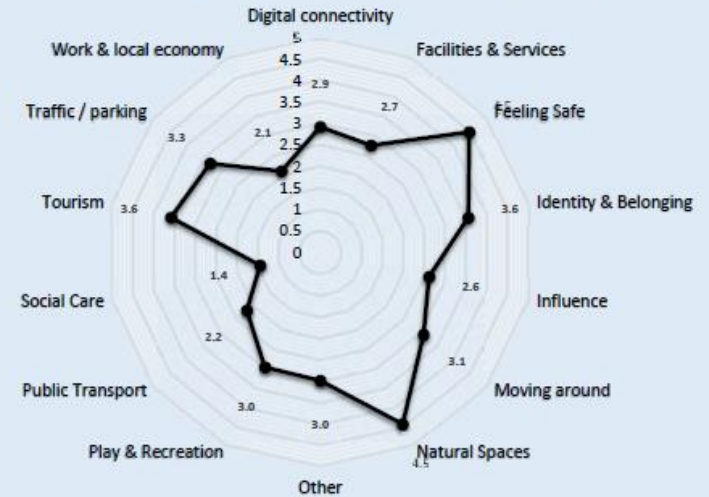

The infographic, created using data and analysis from Annex A, provides a clear visual overview of community sentiment and priorities within the Kirkmaiden Place Plan

(This document has been prepared in accordance with the Scottish Government's Local Place Plan framework and aims to align with the Local Development Plan and national policy priorities.)

Action Plan

This section outlines key projects to achieve the Kirkmaiden Place Plan (PP) objectives. Each action aligns with community priorities, ensuring a practical, fundable, and sustainable roadmap for Kirkmaiden's future.

1. Drummore Harbour Regeneration and Coastal Development

◆ Project: Harbour Clean-Up & Infrastructure Upgrade

Introduction

Drummore Harbour was built in the early 19th century to serve a lime manufacturing industry, having been an easily accessible anchorage sheltered from westerly winds for some time prior to that. It has previously been owned / managed by the Ministry of Defence and the Drummore Harbour Trust until the Kirkmaiden Community Harbour Trust took responsibility in 2018 and continue to manage the harbour. It remains in use for pleasure craft & some active fishing craft and is often the launch site for the popular sea fishing events organised by Mull of Galloway Sea Angling Federation (MOGSAF) and the Clashwhannon Holiday Park.

However, the state of the now derelict premises adjacent to the harbour area has been a concern for the residents of Kirkmaiden for some years. An old boathouse ("Harbour Garage, Harbour Road, Drummore" title deed WGN3138) is locally known as "the birdcage" and mentioned in the responses as the "birdcage" or skeleton building" and referred to as an "eyesore". This was the most frequently mentioned *Dislike, Improvement* and *Project* in the survey responses. See Annex A. With appropriate sea defence, infrastructure improvements and upgraded facilities, the harbour area has the potential to become an attractive and welcoming place that both residents and visitors can be proud of.



Aerial Image of Drummore Harbour

Responses Include:-

Disliked *"The **harbour**, mainly the **birdcage** eyesore."*

Disliked *"The eyesore **birdcage** and scrapyard at the **harbour** in Drummore"*

Disliked *"The **harbour** area & **skeleton** building spoils the whole village of Drummore"*

Would like to see *"Improve the **harbour**. Demolish the **birdcage** and generally improve the harbour environment to make it a focal point for the community Create a space for the benefit of visitors & the community."*

Would like to see *"Better use of the "**birdcage**" and surrounding areas."*

A project for the *"Resolution of the eyesore at the **harbour** which blights the whole village. The land could be used for car park and picnic / recreation amenity area."*

A project to *"Remove boatshed and clean up **harbour** to make it more inviting"*

Action Harbour Clean-Up & Infrastructure Upgrade:

- **Phase 1:** Remove derelict structures, clean up debris, plan out new sea defences and improve general safety of the harbour area



Image of The Boathouse and Harbour Entrance (Approx Jan 2025)

- **Phase 2:** Develop improved facilities for local fishermen, leisure craft, and eco-tourism incl. installing pontoons, providing essential water facilities and electric charging locations including EV.



Artist Impression of Pontoons to Facilitate Residents and Visitor Boats

➤ **Phase 3:** Construction of a Multi-use Community Clubhouse



Artists Impressions of a New Boathouse at Drummore

Community Space - Co-Working Space - Heritage & Tourism Point
Marine Facilities - Shower Facilities - Fitness Suite



Artists Impressions of a New Boathouse at Drummore



Artists Impression of a New Boathouse at Drummore

- **Phase 4:** Host Pop up / Seafood markets, expand the heritage and tourism hub and identify the best locations for a community swimming pool whilst also developing facilities for marine activities.

Outcome:

- ✓ A safer and more functional harbour for local economic and tourism use.
- ✓ Boosting sustainable marine businesses, including fishing and leisure boat services.
- ✓ Preservation of Kirkmaiden's maritime heritage for future generations.
- ✓ Extending the harbour facilities for more general community use.

Timescale: Phased (2-10 years)

Potential Funding Sources:

- Coastal Communities Fund
- Scottish Government Rural Development Grants
- Marine Scotland & South of Scotland Enterprise (SOSE)
- Heritage Lottery Fund

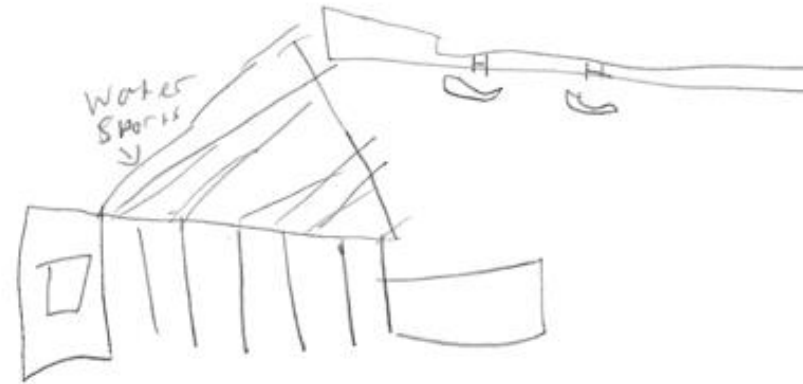

2. Public Transport

◆ Project: Public Transport Expansion & Elderly Accessibility Support

Introduction

Currently the Kirkmaiden community is served by a bus service that is considered by residents as “limited” and not providing a Sunday service. The service provides 6 buses daily Monday to Friday and 5 on Saturday, and goes no further than Drummolee village.

There are concerns that the buses do not really allow for a full working day and do not provide any evening or Sunday service; the latest return from Stranraer being 18:05.

Suggestions from respondents include more frequent bus services or a community bus service that would aid in getting residents to vital medical appointments or able to catch cross-county services to Dumfries.



Responses Include :-

Disliked the “*Limited bus service*”

They would like to see “**More buses**, particularly on *Sundays*”

A project to “Obtain funding to create volunteer network / minibus - day care services / lunch club for older people. Supplement to public transport, such as Octobus or dial-a-bus.”

A project “Extension of the bus service to Damnaglaur or beyond towards Mull”

📌 Action:

- Negotiate improved bus services with Dumfries & Galloway transport authorities.
- Community-led minibus service for elderly residents and young people.

🎯 Outcome:

- Better connections to Stranraer and other key destinations especially health care facilities.
- Improve the viability of travelling to Stranraer for work, education and leisure reasons.

🕒 Timescale: Short-Term (1-3 years)

💰 Potential Funding Sources:

- Transport Scotland Rural Mobility Grant
- Local Authority Accessibility Fund

3. Traffic Infrastructure Improvements

◆ Project: Traffic Infrastructure Improvements

Introduction

Kirkmaiden community is a very rural one. It is accessed via the A716 from Stranraer, the nearest town with wider services. The road network, while scenic, presents challenges including:

- Narrow roads and limited passing places
- The A716 is closed during severe high tides and stormy weather with only a minor road servicing the community
- The A716 is, in part, the only access road to the community which can become isolated if it is blocked between Ardwell and Logan Toll.

Further, the community has raised concerns about the speed of traffic through the villages and rural connecting roads, highlighting the speed of tractors and some visitors to the region. Respondents also raised concerns over the state of the roads and verges. Within Drummore additional concern was raised about the lack of parking for cars, in particular on Stair Street and Mill Street, where many homes do not have access to off-street parking. In addition to improved parking it was thought that the establishment of improved car parking could also provide charging points for Electric Vehicles, noting that there are only 2 public electric car charging points in the community (Logan Botanic Gardens), which may not be always available due to the opening times of the gardens and are situated several miles from the community villages.

Responses include:

Dislike *“Speeding drivers through Stair Street in Drummore. There have been 2 bad crashes this year 2024.”*

Dislike *“The speed of farming machinery on narrow roads & some visitors”*

Dislike *“Too much traffic and speeding through Kirkmaiden hamlet. (Farm vehicles included.)”*

Would like to see a *“Parking area in Church Street (Stair Street) to get cars out of the way.”*

A project to create a *“Car park in the village”* and *“Local provision of electric charging points for cars”*



View Down Stair Street

Action:

- Introduction of speed restrictions, traffic calming or existing restrictions being made stricter.
- Car Parking Spaces creation with EV charging locations.



Property with Car Parking Currently on The Market

Outcome:

- ✓ Safer streets within the community for drivers, pedestrians and all other road users.
- ✓ Reduced congestion, improved use of facilities

Timescale: Short-Term (1-3 years)

Potential Funding Sources:

- Transport Scotland Rural Mobility Grant
- Local Authority Accessibility Fund

4. Local Business, Employment & Economic Growth Initiatives

Project: Business Incubator & Local Trade Support

Introduction

The Kirkmaiden community businesses are predominantly :-

- Agricultural & fishing related (there are several active farms and some active fisher people within the community)
- Tourist related (2 static caravan parks and several tourist destinations)
- Resident & tourist supported (cafes, pubs, shop, galleries & gardens)



The Harbour hosts Active Commercial and Leisure Craft

The nearest area for larger scale employment opportunities is Stranraer which is a 30-minute drive and not well served by public transport (See

action “Public Transport” above.) It should be noted that a significant proportion of the community population are older and likely retired.

Respondents were however concerned about the lack of employment opportunities and also the struggle in getting trades people to visit the locality which is considered by some as quite remote. These challenges are not restricted to the Kirkmaiden locality only but part of a general trend, especially when considering agricultural employment for example. It was also considered that improved broadband connectivity could support home-office based working to provide some with a better work / life balance.

Responses include :-

Disliked that *“Broadband provision is poor”*

Disliked that *“Lack of connectivity that might encourage business development”*

Disliked that there is *“Not enough local trades people for the demand and not enough small businesses for people who can't get into town.”*

Disliked that *“There doesn't appear to be opportunity for anyone to develop business - i.e. premises for commercial enterprise.”*

Would like *“Council initiative to grow new business run by locals.”*

A project to *“A community project to bring together freelancers, people who want to start businesses & graduates from college, with fast broadband, IT support, desks & meeting spaces.”*



Action:

- **Create a Local Business Directory and Networking Hub** to support small businesses and entrepreneurs.
- **Encourage the increase in fibre connectivity** throughout the region (NB. As of the time of this Place Plan there is active work to roll-out fibre based connectivity broadly though the community but it is as yet unknown whether this will reach all households or just the key settlements.)
- **Develop a Local Farmers' and Makers' Market** to showcase regional products.

Outcome:

- ✓ More job opportunities and local economic resilience.
- ✓ Stronger connections between businesses and the local community.

Timescale: Ongoing

Potential Funding Sources:

- South of Scotland Enterprise (SOSE) Small Business Grants
- National Lottery Community Fund

5. Youth Engagement & Educational Programs

◆ Project: Kirkmaiden Youth Hub & Activity Centre

Introduction

The community survey looked to reach out to the younger members of the community and received 31 responses from the children in the local school (under 12s - See Annex A) but no responses from young adults. There are however adult responses also commenting on challenges and opportunities for the young of the community. Currently, from a young people's perspective, the community is served by the popular Drummore Primary School which includes accessible sports fields and a playground. However older children travel to Stranraer by bus for their schooling and any significant extra-curricular activities & interests for all children are only served out with the community.

The survey identified that the improvement in the provision of activities for children of all ages within the community was a priority but the children also identified that better care could be taken of their environments, especially the playpark.



Children's Play Area Drummore

Responses Included :-

Disliked that *"There isn't enough swings at the park."*

Disliked *"The litter and dog poo problem."*

Would like to see *"More family activities."*

Would like to see *"More things in the park."*

Would like to see *"Young farmers for under 14s"*

Would like to see *"A big grassy / forestry area, A Young farmers for under 14s."*

Would like to see *"Better park in Port Logan and activities for children in the holidays. Young farmers for under 14s."*

Action:

- ✓ Establish a youth club with structured activities (e.g., MUGA, arts, sports, coding, farming).
- ✓ Partner with schools & local farms for an Under-14 Young Farmers' Group or similar Under 14's Youth Group. (The suggestion of a Young farmers group for under 14s group was particularly popular. The Place Plan Steering Group has therefore already looked into this but note that, as far as we are concerned, the Young Farmers organisation do not provide for under 14s. However, the principle of organised activities, perhaps with a focus on children of farming families, may be more feasible).

Outcome:

- ✓ More activities for young people increasing opportunities for socialisation.
- ✓ Stronger youth involvement in community projects.

Timescale: Short-Term (1-2 years)

Potential Funding Sources:

- Youth Scotland Development Fund
- Tesco Community Grants



a climbing wall.

6. Environmental Sustainability & Conservation

Introduction

The Kirkmaiden community has an extensive coastline with several bays. The bays have had several coastal clean-ups organised by O N US South West Scotland. The Rhins of Galloway Coast Path traverses much of the Kirkmaiden coastline and the locality is a popular area for visitors, but this brings its own challenges and pressures on local facilities. Problems with the public toilet facilities were raised by respondents, especially in Port Logan which is a popular location for tourists and overnight campers.

Responses included :-

Disliked “*Rubbish on beaches / roadsides*”

Disliked “*Litter - sweet wrappers and lots of bags of rubbish left near bins by tourists*”

Disliked “*Few public toilets. People leaving excrement.*”

Would like to see improvements in “*Visitor facilities - particularly lavatories in Port Logan and modern 'composting' toilets along the growing network of long distance footpaths.*”

Would like to see “*More community volunteer clean ups and beach cleaning participation.*”

A project for “*Improved toilet facilities for visitors.*”

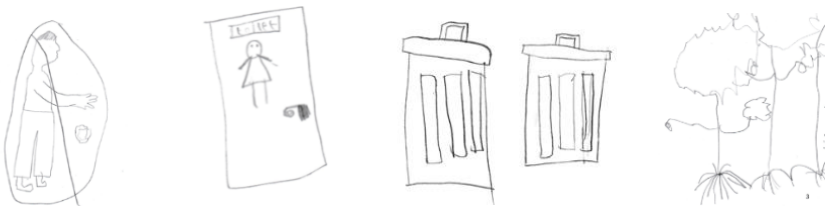

◆ Project: Coastal & Green Space Preservation

📌 Action:

- Organise regular beach and countryside clean-ups.
- Develop conservation programs, including tree planting and erosion control.
- Improve public toilet facilities in Port Logan and Drummore.

🎯 Outcome:

- ✓ Preserved natural landscapes, improved biodiversity and better well-being.
- ✓ Reduced environmental impact of tourism. (See also the section Tourism below.)

⌚ Timescale: Ongoing

💰 Potential Funding Sources:

- NatureScot Conservation Grants
- Community Recycling & Sustainability Funds

I think every week on friday everyone does a masive big clean up!

7. Community Skill Development & Volunteering

Introduction

Whilst the Kirkmaiden community does have an older demographic the survey indicated that people would be keen to learn new skills, share experience and set up new interest clubs.

Responses include :-

A project for *“Skill swapping”*

A project for a *“Gardening club”*

A project for *“A community space more suitable for all”*

A project for *“More use of the Hub by groups / clubs”*

A project for *“Evening classes in the school e.g.. Languages, cooking etc.”*

◆ Project: Community Skill-Sharing Network

📌 Action:

- Establish workshops on gardening, cooking, digital skills, and crafts.
- Offer volunteer training programs for community-led initiatives.

🎯 Outcome:

- ✓ Stronger community connections and increased skill-sharing opportunities.
- ✓ Support for unemployed residents to develop new skills & careers.

🕒 Timescale: Short-Term (1-3 years)

💰 Potential Funding Sources:

- Skills Development Scotland Grants
- Foundation Scotland Community Funds



The local flower show, where creativity blooms in every corner

8. Community Cohesion and Well-being

Introduction

Historically the community had a number of activities that would have suited the promote community cohesion & well-being including a bowling club & tennis courts. Respondents to the survey thought facilities such as these and others would help restore cohesion and well-being of the residents.



Tennis Courts, Drummore.

Image showing the historically significant Drummore Tennis Courts

Further, respondents found that Social Care services were lacking and should be improved. It was noted that whilst NHS services was considered “Good” the provision of Social Care services was rated “Poor”.

Responses Include :-

Disliked “*Poor social care for elderly & sick*”

Disliked “*Lack of social care support*”

Would like to see “*Something to keep teenagers entertained (like kids bowling camp through the summer)*”

Would like to see “*The tennis courts being renovated so people can use*”

Would like to see “*Somewhere for children to go to meet friends, play games and socialise*”

Would like to see “*Rural healthcare advocacy so that we are not completely forgotten by Dumfries (and Stranraer to some extent).*”

A project for “*Improved access to health services and social care.*”

A project to “*Re-introduce the tennis courts and have a new clubhouse*”

A project to “*Make more of the playground. Split into the playground and a MUGA.*”

A project to “*Do walk-a-buddy. Get older residents out of houses once a week and walk the low road loop - with a child / younger companion*”

◆ Project: Community Cohesion and Well-being

📌 Action:

- Establish multi-generational **Multi-Use Games Area**.
- Lobby for improved access to **Social Care Services** where the provision of Care Services was reported as Poor. Seek partnership with other care related services & charities such as the Stranraer Cancer Drop-In Centre.

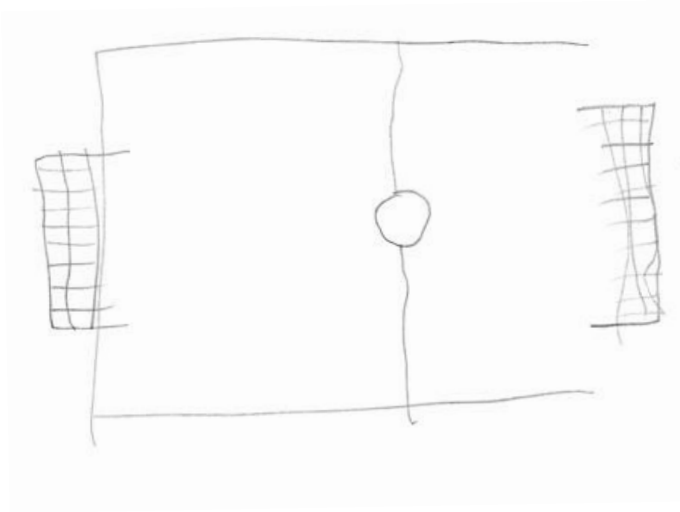

🎯 Outcome:

- ✓ Improved sense of cohesion within the community.
- ✓ Improved health, well-being and care of the residents.

🕒 Timescale: Short-Term (2-4 years)

💰 Potential Funding Sources:

- Sport Scotland Facilities Fund
- National Lottery

9. Better Managed Tourism

Introduction

In addition to the general attraction of the local region (beaches, walks, countryside etc) there are several tourist attractions within the parish including the Mull of Galloway Lighthouse and reserves (Scotland's most southerly point), Port Logan Fishpond, Logan Botanic Garden, Logan House Gardens and Mull of Gallery studio. Further, the parish contains several established holiday rental properties, two static caravan parks and two touring caravan & motorhome parks. These all provide employment for residents and income to local businesses such as the shops, pubs & cafes, and facilities that are enjoyed by visitors and residents alike. However, as shown above, these benefits come with related challenges, so improving the management of tourism could help visitors to better enjoy the environment they come to see and residents feel less impacted by the tourism and also better able to enjoy the environment in which they live.



Image of New England Bay

◆ Project: Better Managed Tourism

📌 Action:

- Support Dumfries & Galloway Council regarding their plans for managing tourism, including New England Bay.
- Improve the safety signage at frequently visited coastal spots.

New England Bay

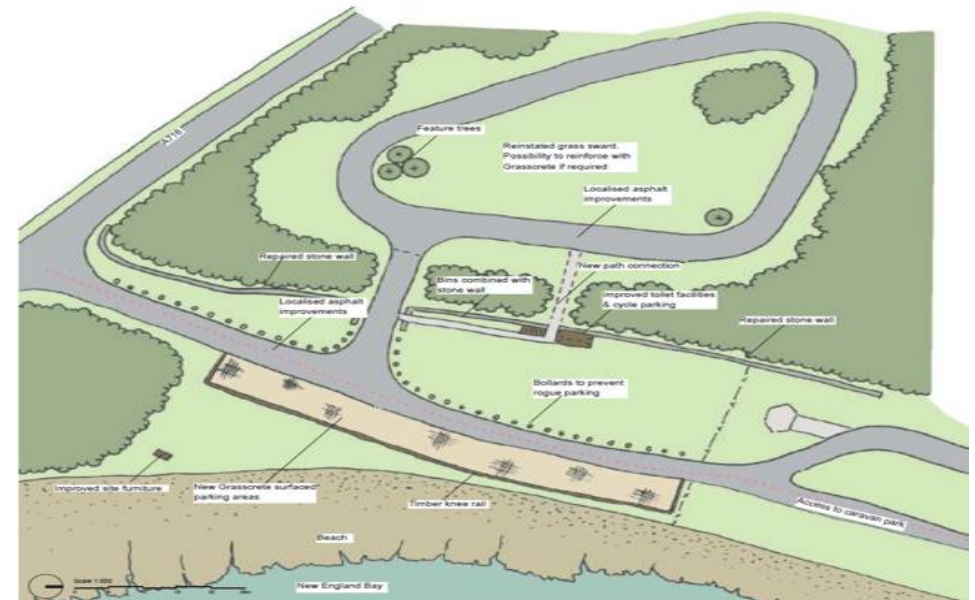

Image showing proposed motorhome management plan

🎯 Outcome:

- ✓ Better managed & designated areas for campervans, motor homes and "wild" camping.
- ✓ Fewer emergency services callouts and a safer environment for residents & visitors.

🕒 Timescale: Short-Term (1-3 years)

 **Measuring Success**

- To ensure meaningful progress, the Kirkmaiden Place Plan Steering Committee will meet regularly to review the advancement of key projects, assess community impact, and monitor the success of funding applications.
- Success will be measured not only by completed infrastructure but by increased community participation, enhanced local services, and long-term benefits to residents and visitors alike.

 **Conclusion: A United Vision for Kirkmaiden's Future**

With community collaboration, targeted funding, and strong leadership, Kirkmaiden can become a model of sustainable rural development. By focusing on harbour revitalisation, economic growth, youth engagement, and environmental conservation, this plan provides a clear, practical strategy for the next 10 years.

This Place Plan belongs to everyone in Kirkmaiden. Success depends on the continued involvement, passion, and support of local people, businesses, and visitors. Whether through volunteering, participating in events, running businesses, or championing Kirkmaiden's story, every contribution will help shape a thriving, resilient, and welcoming community for generations to come.



Asset Development Plan
 Key land, buildings, and natural assets in Kirkmaiden have been identified as potential sites to be retained, improved, or developed to meet the community's long-term goals. These assets are essential to supporting economic growth, social well-being, infrastructure improvements, and environmental sustainability.
Any future acquisitions must be at fair market value.

1. Drummore Harbour Regeneration and Coastal Development
2. Public Transport
3. Traffic Infrastructure Improvements
4. Local Business, Employment & Economic Growth Initiatives
5. Youth Engagement & Educational Programs
6. Environmental Sustainability & Conservation
7. Community Skill Development & Volunteering
8. Community Cohesion and Well-being
9. Better Managed Tourism

Annex A

Kirkmaiden Community Survey

Between July and September 2024 community consultation forms were distributed by volunteers in the Steering Group to as many homes and properties within the community as possible. Where possible the purpose of the consultation was explained and the community encouraged to participate. Two consultation meetings were also held in the local hubs of Kirkmaiden Community Hub in Drummore and Port Logan Hall. Approx 750 consultation forms were made available; 31 young people (up to 16 years old) responded and 149 adults (16+ years old) responded. The responses in the completed forms received have been entered into a spreadsheet where it has been analysed to inform the Place Plan detail above.

Key Quantitative Findings

These findings are the counts and direct responses to the key questions on each consultation form.

Young People's Feedback

Total count 31.

Where do you live

Port Logan	Drummore	Kirkmaiden	Mull of Galloway	Damnaglaur	Maryport	Other	Blank
1	22	2	0	4	0	1	1

Age Range

3-6	7-9	10-12	Blank
2	10	18	1

Adult's Feedback

Total count 142.

Where do you live

Port Logan	Drummore	Kirkmaiden	Mull of Galloway	Damnaglaur	Maryport	Other	Blank
26	85	11	13	4	3	7	0

How would you identify yourself

Resident	Visitor	Works	Interest	Other	2nd home	Blank
139	3	1	1	2	3	0

How long have you lived here (years)

Average	Don't live here	Visit regularly	Blank
17.2	1	5	2

Breakdown

0-5	5-10	10-20	20+
39	32	26	44

Do you plan residing here in 10 years

Yes	No	Don't know	Blank
122	6	0	2

Age Range

16-24	25-44	45-64	65-74	75+	Blank
1	15	61	49	23	0

Key Quantitative Findings

Young People's Feedback

Young people were asked to respond to the following questions.

- “Please tell us what you like most about where you live?”
- “Please tell us what you don’t like about the area where you live?”
- “Please tell us what you like to see in the area that you live?”
- “Describe your community in one word.”
- “Please describe, or supply a drawing attached to this questionnaire, of any ideas that would make you community better for you and your friends?”

The data from the responses to these questions informs the general content of the Place Plan. Key word searches on the Likes, Dislikes, Like to See and Pictures suggests areas for attention in each of these categories. E.g. “Farmer” often relates to a suggestions for a Young Farmers Under 14s group and “Dog” often relates to dislike of dog fouling in the young people’s environments.

Likes	Park	Beach	Farm	View	Friend	People	School	Quiet	Harbour	Natur
Count	10	8	7	6	4	4	3	2	1	1
Dislikes	Litter	Rubbish	Angry	Rude	Vandal	Park	Harbour	Poo	Noise	Dog
Count	4	1	3	2	3	3	2	2	1	1
Like to see	Park	Farmer	Litter	Poo	Activ	Bus	Activ	Pool	Climb	Ice-cream
Count	8	8	3	3	3	2	3	2	2	1
Pictures	Farmer	Park	Shop	Bus	Tree	Forest	Litter	Sport	Toilet	Bin
Count	7	4	3	2	2	1	1	2	1	1

Adult's Feedback

Adults were asked to respond to the following questions.

- “Overall, how would you rate Kirkmaiden community under the following?”
- “How would you rate the following aspects of life living in the parish of Kirkmaiden?”
- “Please tell us three things you like most about the parish of Kirkmaiden?”
- “Please tell us three things you don't like in the parish of Kirkmaiden?”
- “Please tell us three things you would like to see improved in the parish of Kirkmaiden?”
- “Please tell us three projects / initiatives you would like to see happen in the parish of Kirkmaiden?”
- “What does Kirkmaiden mean to you in one word.”
- “Would you like to expand further anything you have mentioned above or have anything else you would like to add?”

The data from the responses to these questions informs the general content of the Place Plan.

How would you rate Kirkmaiden community

	Great	Good	OK	Poor	Very Poor	Blank	Blend	Blended rating
Live	76	57	12	0	0	4	4.4	Great
Work	13	18	23	42	7	46	2.9	OK
Visit	46	63	18	1	0	21	4.2	Great
Leisure	17	51	49	14	5	13	3.4	Good
NHS	16	56	38	22	11	6	3.3	Good

How would you rate the following aspects of life in Kirkmaiden

* The “Blend” is an averaged value based on a score of 5 for each “Great” through to 1 for each “Very Poor”. The Blended rating is what that Blend value would match on the same 5 to 1 scale.

	Great	Good	OK	Poor	Very Poor	Unknown	Blank	Blend *	Blended rating *
Moving around	4	52	56	27	9	0	1	3.1	Good
Public Transport	1	12	50	44	18	16	8	2.2	OK
Traffic / parking	13	54	54	22	4	2	0	3.3	Good
Play & Recreation	8	38	58	25	5	7	8	3.0	OK
Natural Spaces	85	49	8	3	0	1	3	4.5	Great
Work & local economy	2	21	29	51	9	28	9	2.1	OK
Social Care	3	15	23	19	14	62	13	1.4	Poor
Feeling Safe	78	60	9	0	0	0	2	4.5	Great
Facilities & Services	3	28	62	35	10	5	6	2.7	OK
Digital connectivity	8	39	53	28	19	1	1	2.9	OK
Identity & Belonging	28	61	40	4	1	10	5	3.6	Good
Influence	4	24	70	13	7	19	12	2.6	OK
Tourism	15	61	53	8	1	0	11	3.6	Good
Other	2	1	0	1	2	0	143	3.0	OK

(This document has been prepared in accordance with the Scottish Government’s Local Place Plan framework and aims to align with the Local Development Plan and national policy priorities.)

Key Word Searches

Key word searches on the Likes, Dislikes, Improvements, Projects and Anything Else suggests areas for attention in each of these categories.

Shortened words can help to identify where people have used similar but not the same word. I.e. “Beaut” - beauty, beautiful, “Natur” - nature, natural, “Friendl” - friendly, friendliness, “Hous” - house, houses, housing.

Likes	Peace	Community	Quiet	Scenery	Beaut	Safe	Friendl	Space	Natur	People
Count	39	40	39	16	24	28	47	14	27	27
Dislikes	Harbour	Birdcage	Road	Traffic	Toilet	Speed	Hous	Path	Dog	Bus
Count	32	14	50	15	10	18	12	9	17	10
Improve	Harbour	Birdcage	Play	Road	Passing	Bus	Toilet	Social	Path	Parking
Count	40	11	7	49	11	10	8	7	16	12
Projects	Harbour	Birdcage	Play	Road	Gala	Bus	Tennis	Camper	Hall	Toilet
Count	40	5	8	15	6	15	7	6	7	5
Anything else	Harbour	Birdcage	National	Road	Bus	Community	Camper	Toilet	Elder	Job
Count	6	4	9	4	4	8	2	1	1	3

Some key words pick up on responses that have local context. “Birdcage” references the now derelict old boat shed at the harbour. “Gala” may reference gala days previously held in the village. “Toilet” most likely references public toilets and “Passing” most likely references passing places on the narrow local roads.

Not all instances of one word relate to the same issue but the counts can be helpful in directing analysis.

Word Cloud of “What does Kirkmaiden mean to you in one word.”

